

**Note :**

\*\*\* Bottom Hinge/110 (15.A) is used for products that are produced before 05.07.2005

\*\*\* Bottom Hinge/140 (15.B) is used for products that are produced after 05.07.2005

\*\*\* One Stationary Foot (16) is used for Bottom Hinge/110 (15.A)

\*\*\* Two Stationary Foot (16) is used for Bottom Hinge/140 (15.B)

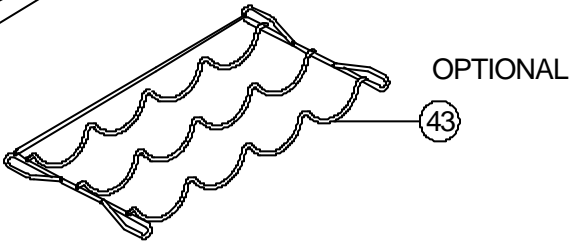
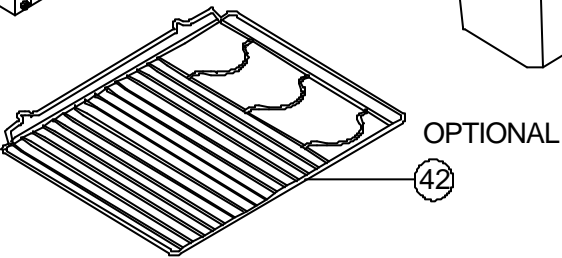
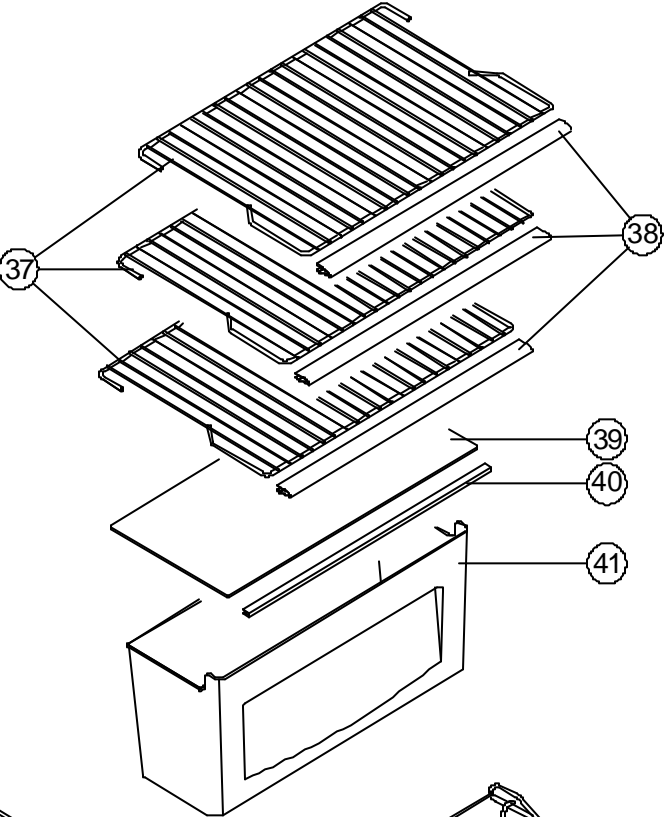
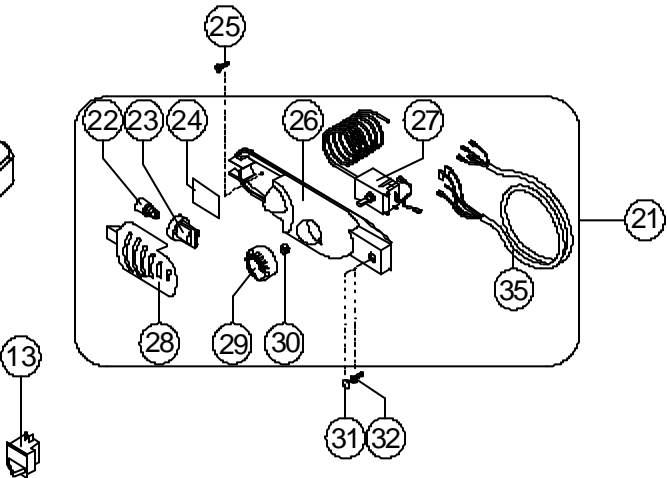
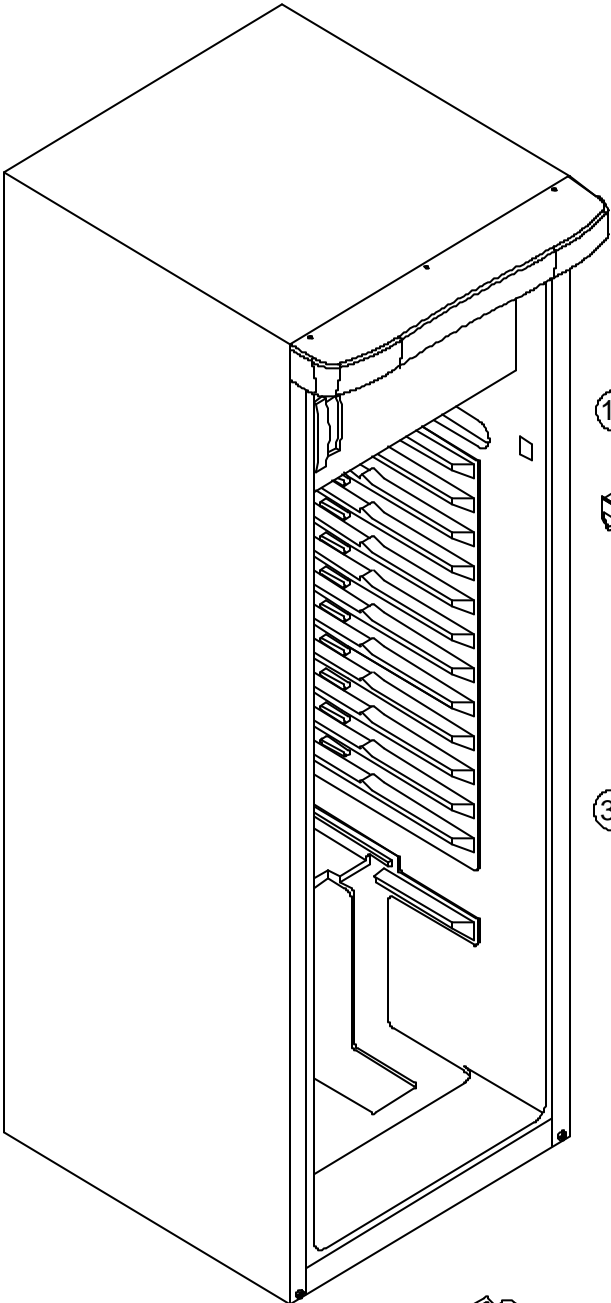

OPTIONAL

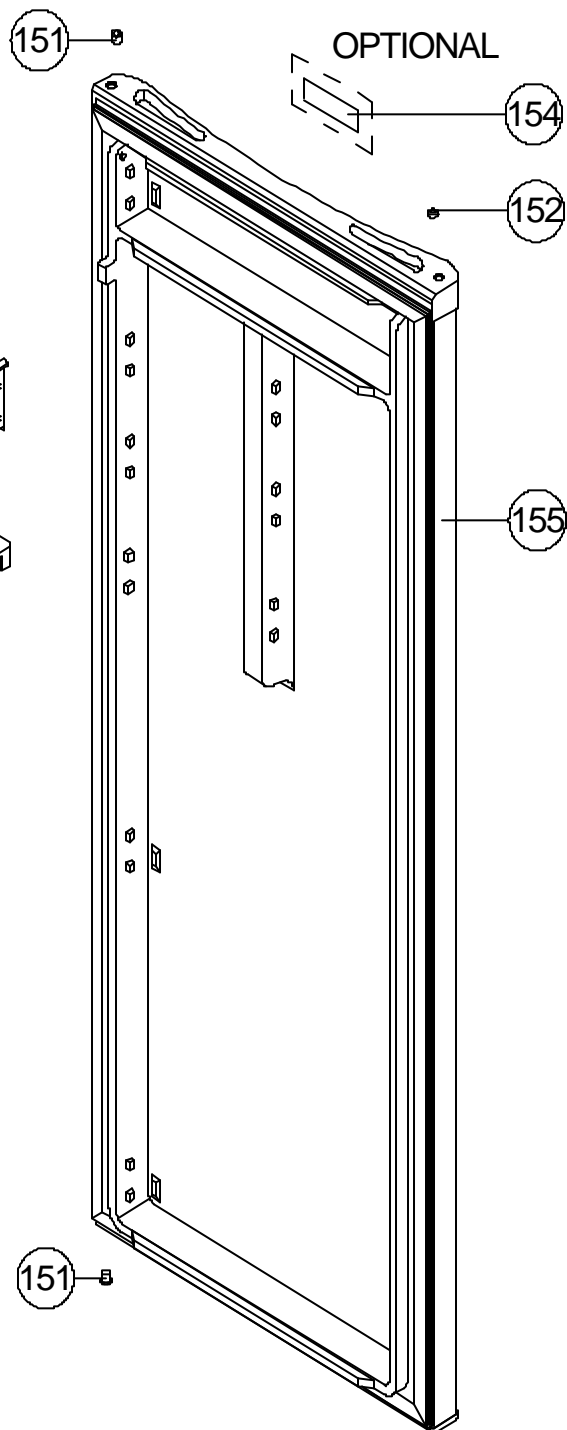
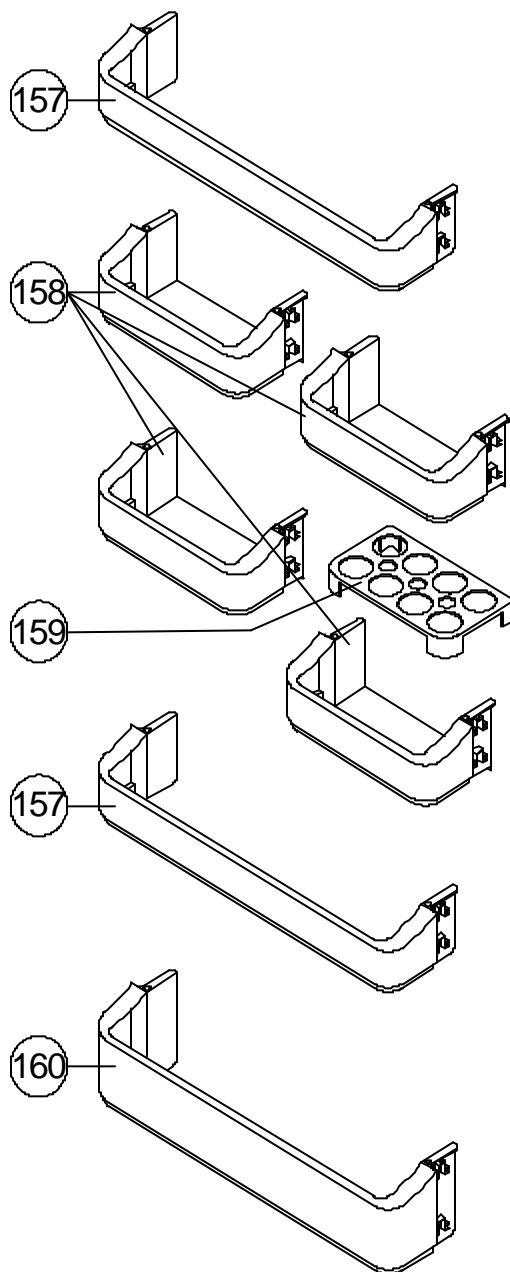
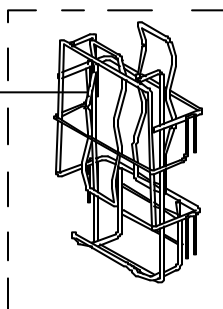

OPTIONAL

