

This exploded view diagram illustrates the assembly of a microwave oven. The central component is the microwave cavity (10). Surrounding it are various parts including the turntable (14), the turntable support (110), the turntable motor (21), the door (16), the door hinge (71), the door latch (117), the door handle (173), the door seal (20), the door gasket (21), the door frame (19), the door trim (4), the door latch assembly (42), the door hinge assembly (45), the door latch assembly (47), the door hinge assembly (48), the door latch assembly (49), the door hinge assembly (60), the door latch assembly (68), the door hinge assembly (73), the door latch assembly (112), the door hinge assembly (114), the door latch assembly (117), the door hinge assembly (173), the door latch assembly (4), the door hinge assembly (7), the door latch assembly (9), the door hinge assembly (10), the door latch assembly (12), the door hinge assembly (13), the door latch assembly (16), the door hinge assembly (19), the door latch assembly (20), the door hinge assembly (21), the door latch assembly (38), the door hinge assembly (328), the door latch assembly (40), the door hinge assembly (42), the door latch assembly (45), the door hinge assembly (47), the door latch assembly (48), the door hinge assembly (49), the door latch assembly (60), the door hinge assembly (68), the door latch assembly (71), the door hinge assembly (73), the door latch assembly (110), the door hinge assembly (111), the door latch assembly (112), the door hinge assembly (114), the door latch assembly (117), the door hinge assembly (173), the door latch assembly (4), the door hinge assembly (7), the door latch assembly (9), the door hinge assembly (10), the door latch assembly (12), the door hinge assembly (13), the door latch assembly (16), the door hinge assembly (19), the door latch assembly (20), the door hinge assembly (21), the door latch assembly (38), the door hinge assembly (328), the door latch assembly (40), the door hinge assembly (42), the door latch assembly (45), the door hinge assembly (47), the door latch assembly (48), the door hinge assembly (49), the door latch assembly (60), the door hinge assembly (68), the door latch assembly (71), the door hinge assembly (73), the door latch assembly (110), the door hinge assembly (111), the door latch assembly (112), the door hinge assembly (114), the door latch assembly (117), the door hinge assembly (173).

13 july 2015

90 CM FREE STANDING COOKER CAVITY ASSEMBLY

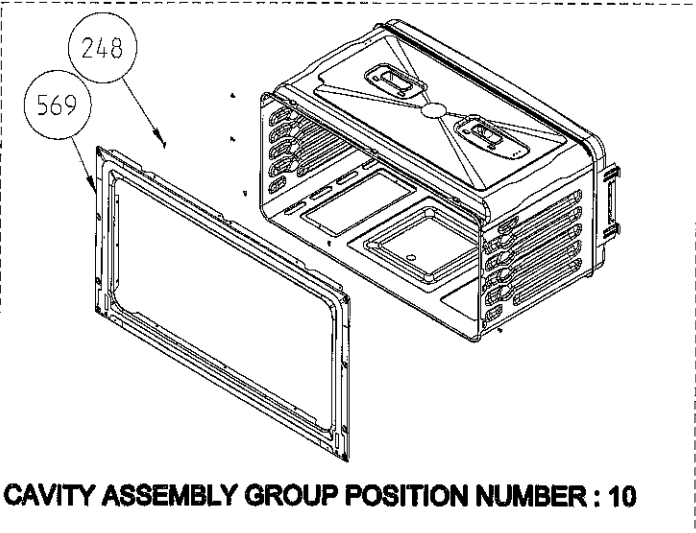
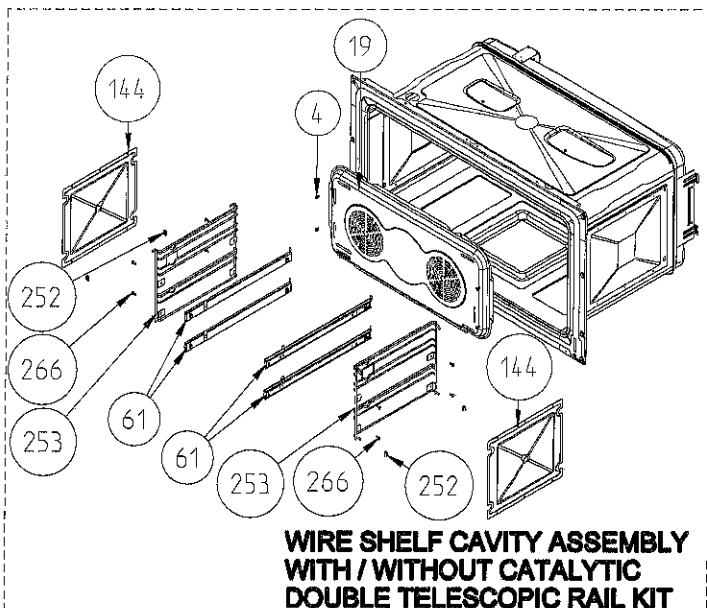
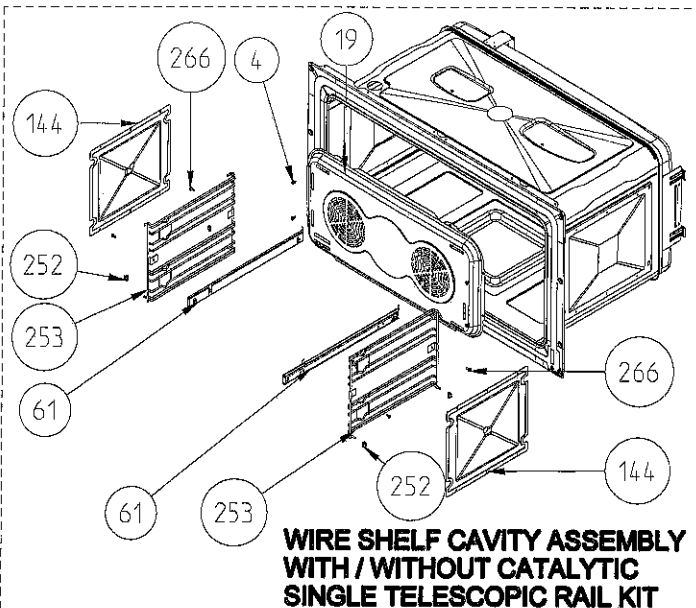
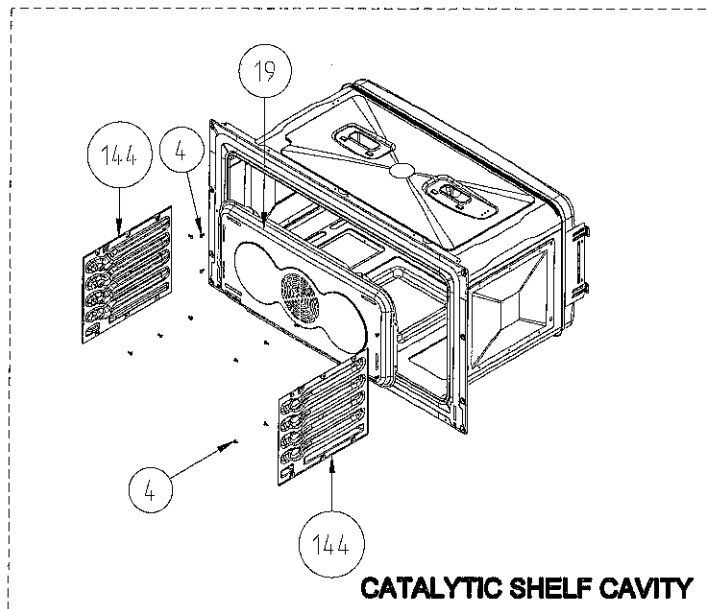
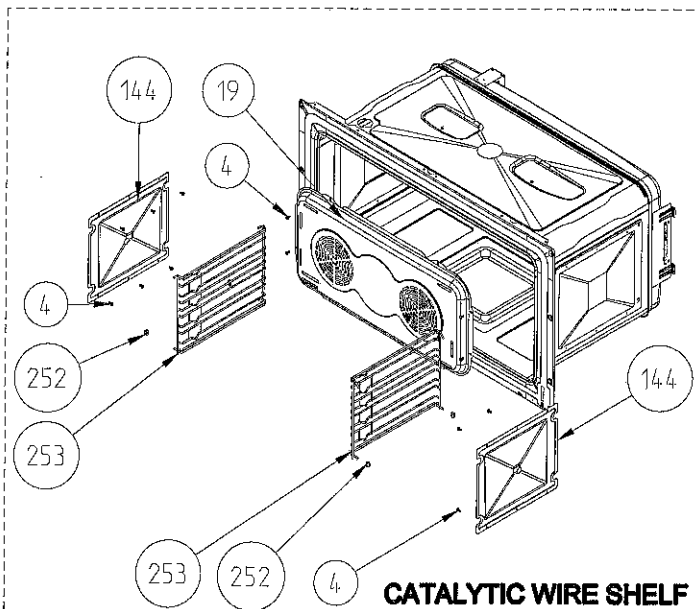

90 CM FREE STANDING COMBINE COOKER CONTROL PANELS

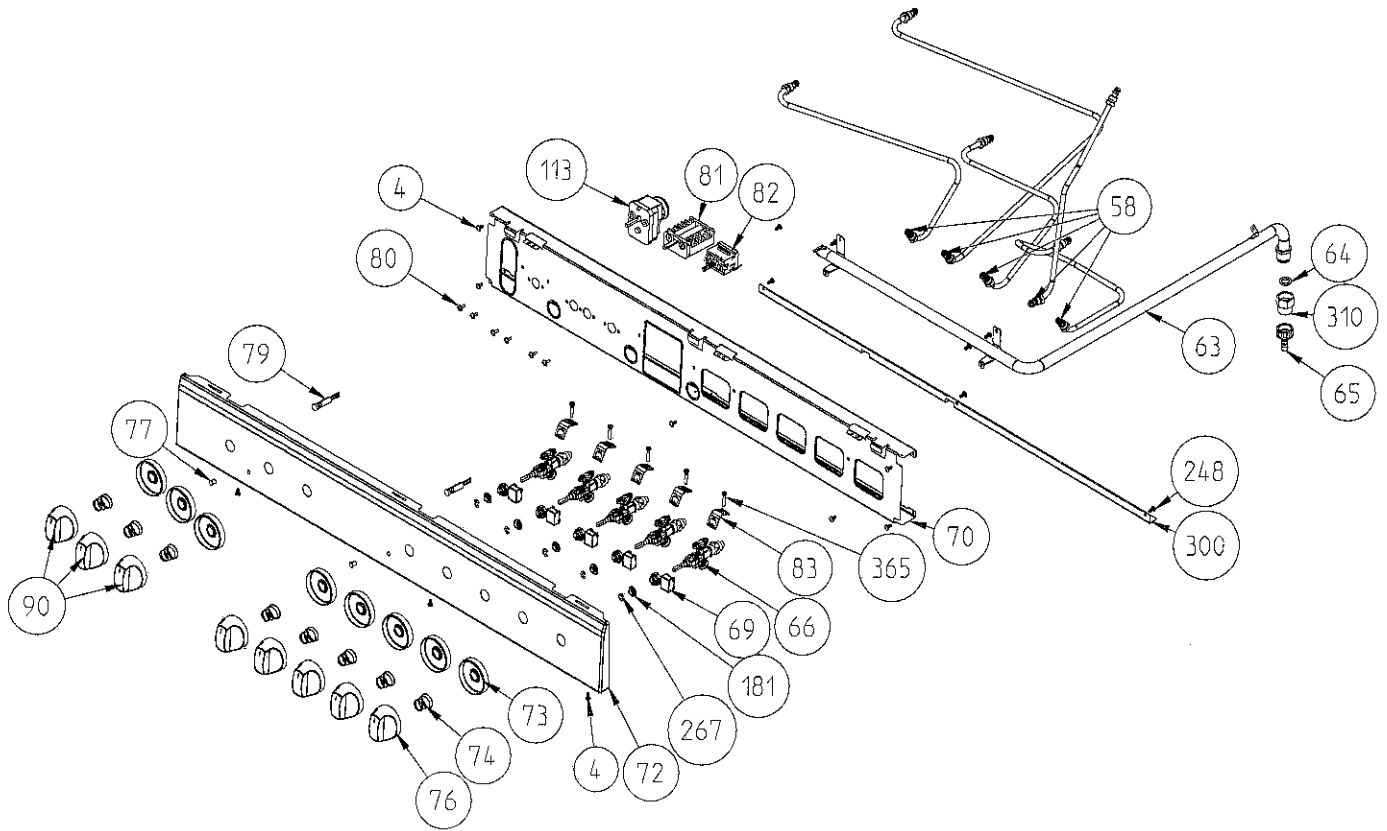

5 GAS OVEN ELECTRIC MECHANIC TIMER CONTROL PANEL

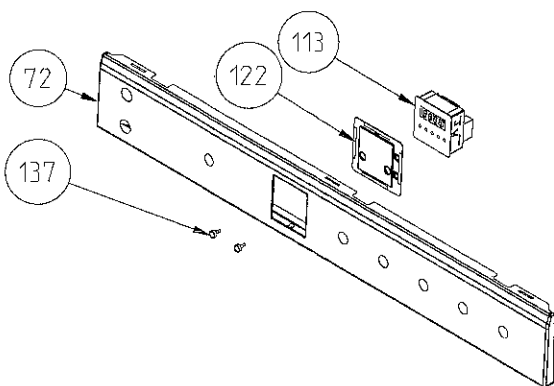

DIGITAL TIMER (OPTIONAL)

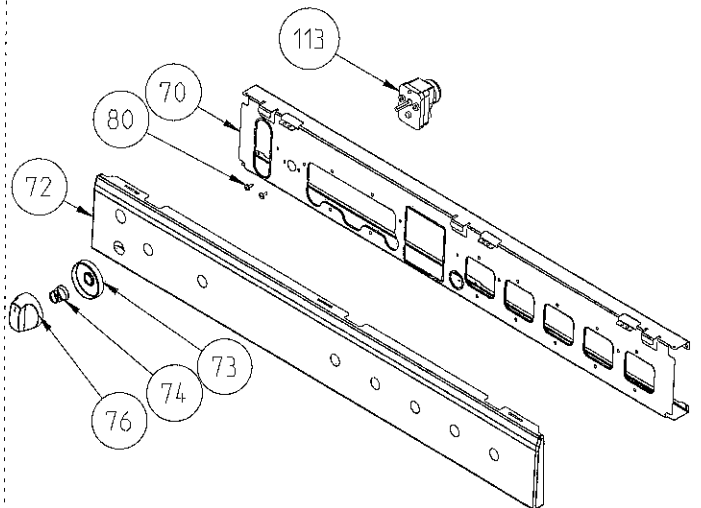

MECHANIC TIMER (OPTIONAL)

90 CM FREE STANDING COMBINE COOKER CONTROL PANELS

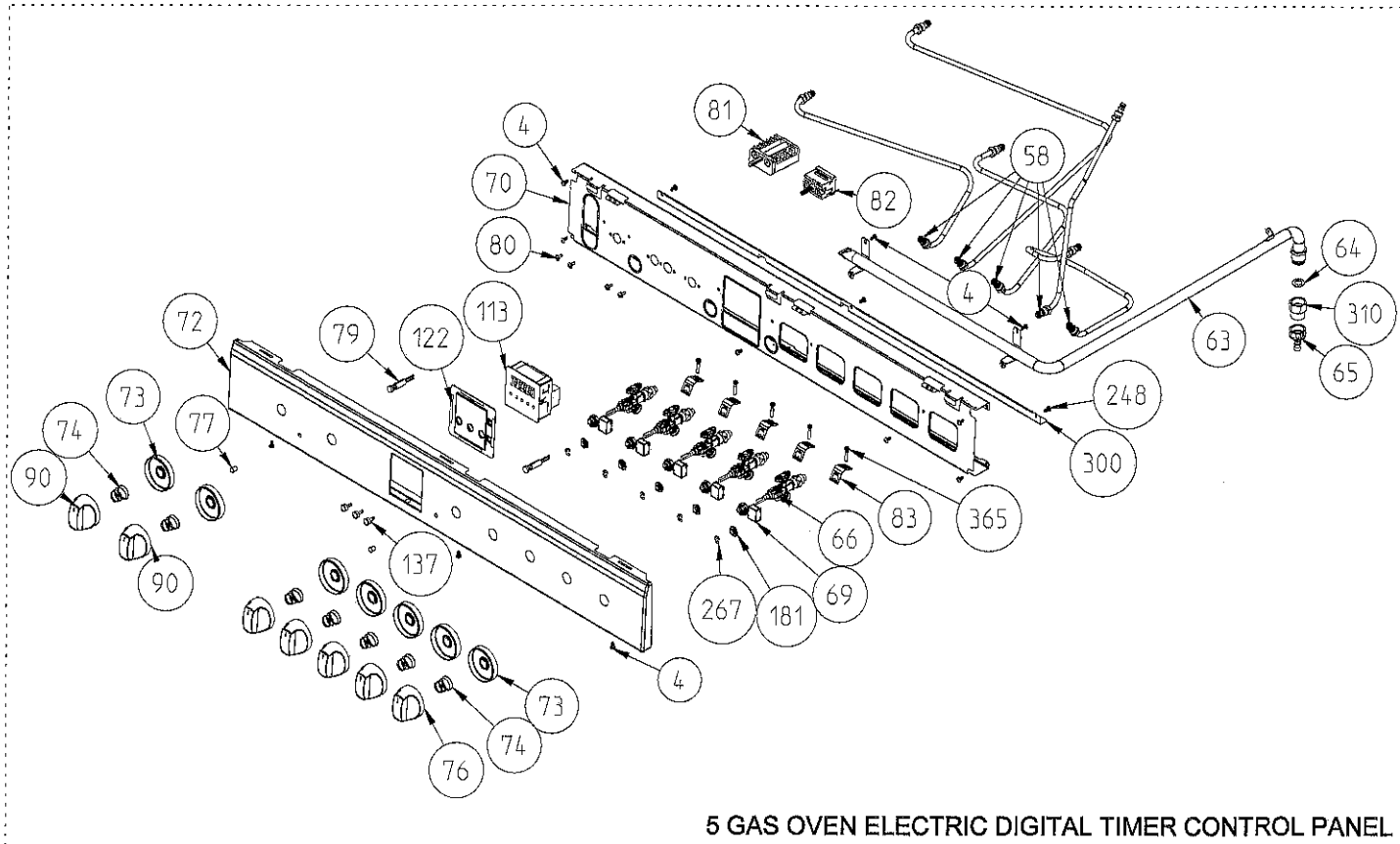

5 GAS OVEN ELECTRIC DIGITAL TIMER CONTROL PANEL

"The exploded views given in this document are generic. They include all possible versions of the product. For specific part codes, please refer to the bom list of regarding model."

13 july 2015

90 CM FREE STANDING COOKER

COOKTOP ASSEMBLY

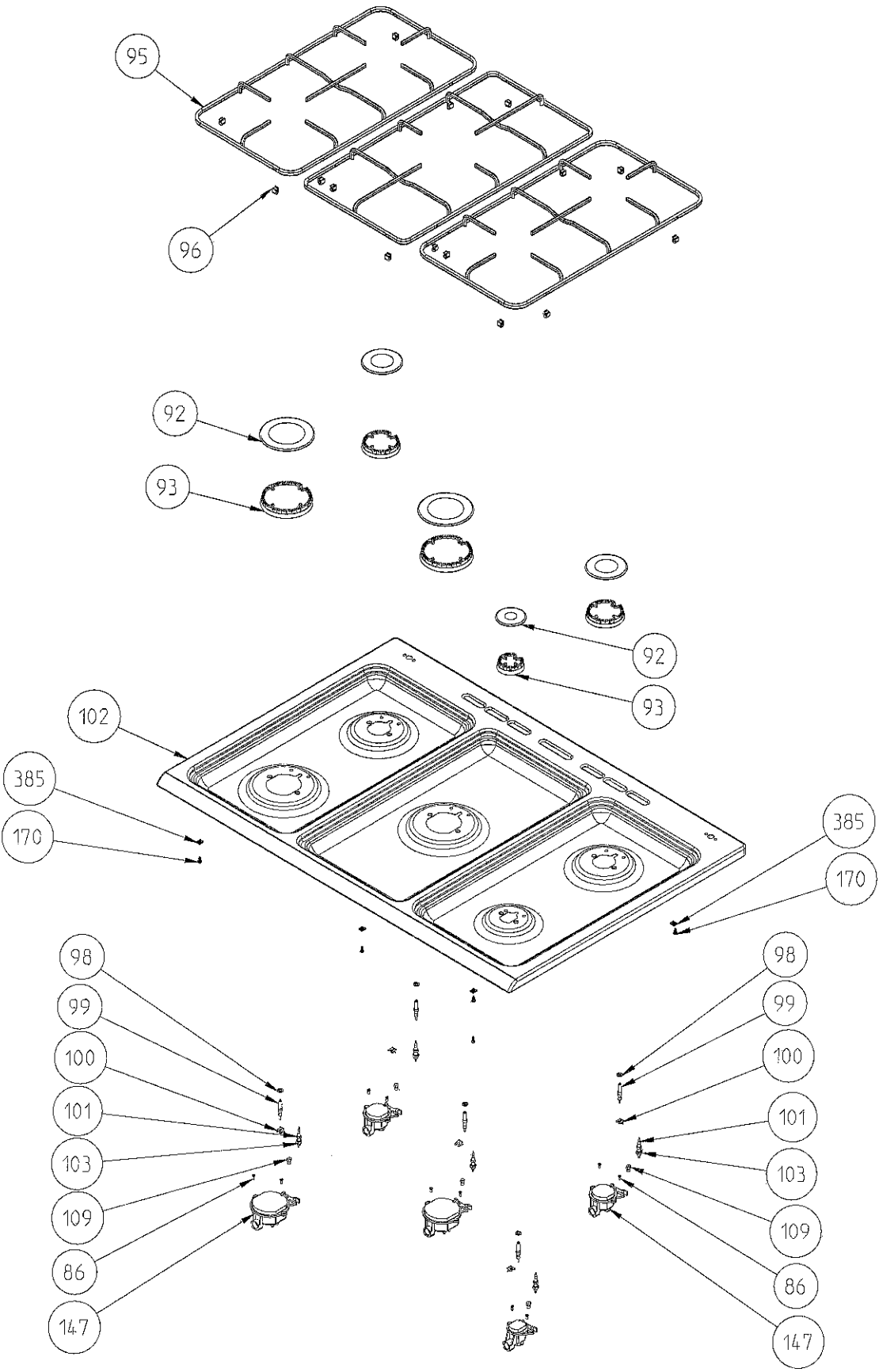

5 GAS
COOKTOP ASSEMBLY

"The exploded views given in this document are generic. They include all possible versions of the product. For specific part codes, please refer to the bom list of regarding model."

This exploded view diagram illustrates the assembly of a gas cooktop. The components are identified by the following numbered callouts:

- 257**: A circular component, likely a burner cap or a part of the burner assembly, located at the top center.
- 95**: A large rectangular frame or support structure, located below the burner cap.
- 96**: A smaller rectangular component, possibly a burner head or a part of the frame, located below the main frame.
- 92**: A circular component, likely a burner cap or a part of the burner assembly, located in the middle section.
- 93**: A circular component, likely a burner cap or a part of the burner assembly, located in the middle section.
- 385**: A rectangular component, likely a burner head or a part of the frame, located on the left side.
- 170**: A rectangular component, likely a burner head or a part of the frame, located on the left side.
- 102**: A rectangular component, likely a burner head or a part of the frame, located on the right side.
- 98**: A small component, likely a burner head or a part of the frame, located on the left side.
- 99**: A small component, likely a burner head or a part of the frame, located on the left side.
- 100**: A small component, likely a burner head or a part of the frame, located on the left side.
- 101**: A small component, likely a burner head or a part of the frame, located on the left side.
- 103**: A small component, likely a burner head or a part of the frame, located on the left side.
- 86**: A small component, likely a burner head or a part of the frame, located on the left side.
- 147**: A small component, likely a burner head or a part of the frame, located on the left side.
- 175**: A small component, likely a burner head or a part of the frame, located in the center.
- 147**: A small component, likely a burner head or a part of the frame, located in the center.
- 98**: A small component, likely a burner head or a part of the frame, located on the right side.
- 99**: A small component, likely a burner head or a part of the frame, located on the right side.
- 100**: A small component, likely a burner head or a part of the frame, located on the right side.
- 109**: A small component, likely a burner head or a part of the frame, located on the right side.
- 101**: A small component, likely a burner head or a part of the frame, located on the right side.
- 103**: A small component, likely a burner head or a part of the frame, located on the right side.
- 86**: A small component, likely a burner head or a part of the frame, located on the right side.
- 147**: A small component, likely a burner head or a part of the frame, located on the right side.

13 july 2015

90 CM FREE STANDING LID ASSEMBLY

COOKER

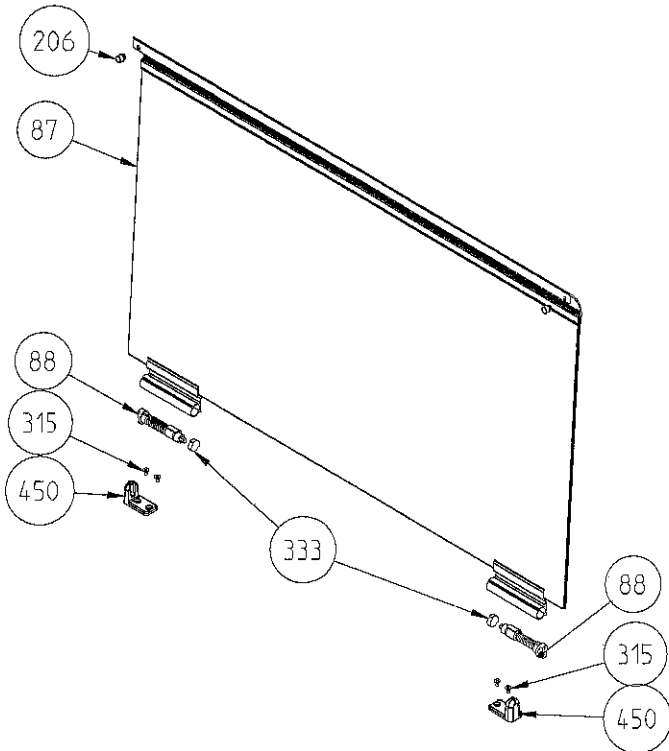

GLASS LID COVER ASSEMBLY WITH PROFILE

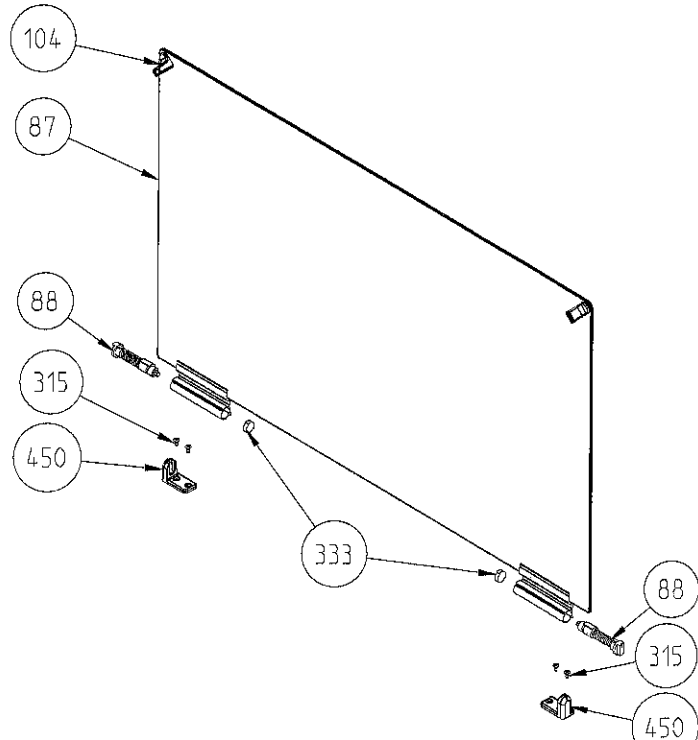

GLASS LID COVER ASSEMBLY WITH BUMPER

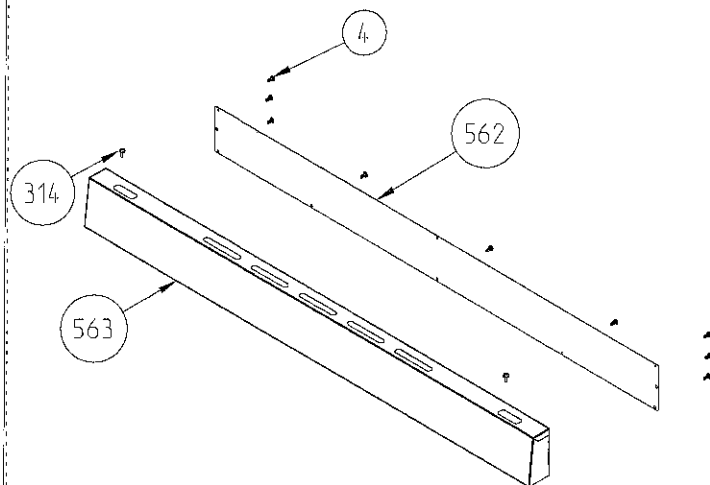

"The exploded views given in this document are generic.They include all possible versions of the product.
For specific part codes,please refer to the born list of regarding model."

90 CM FREE STANDING COOKER OVEN DOOR ASSEMBLY

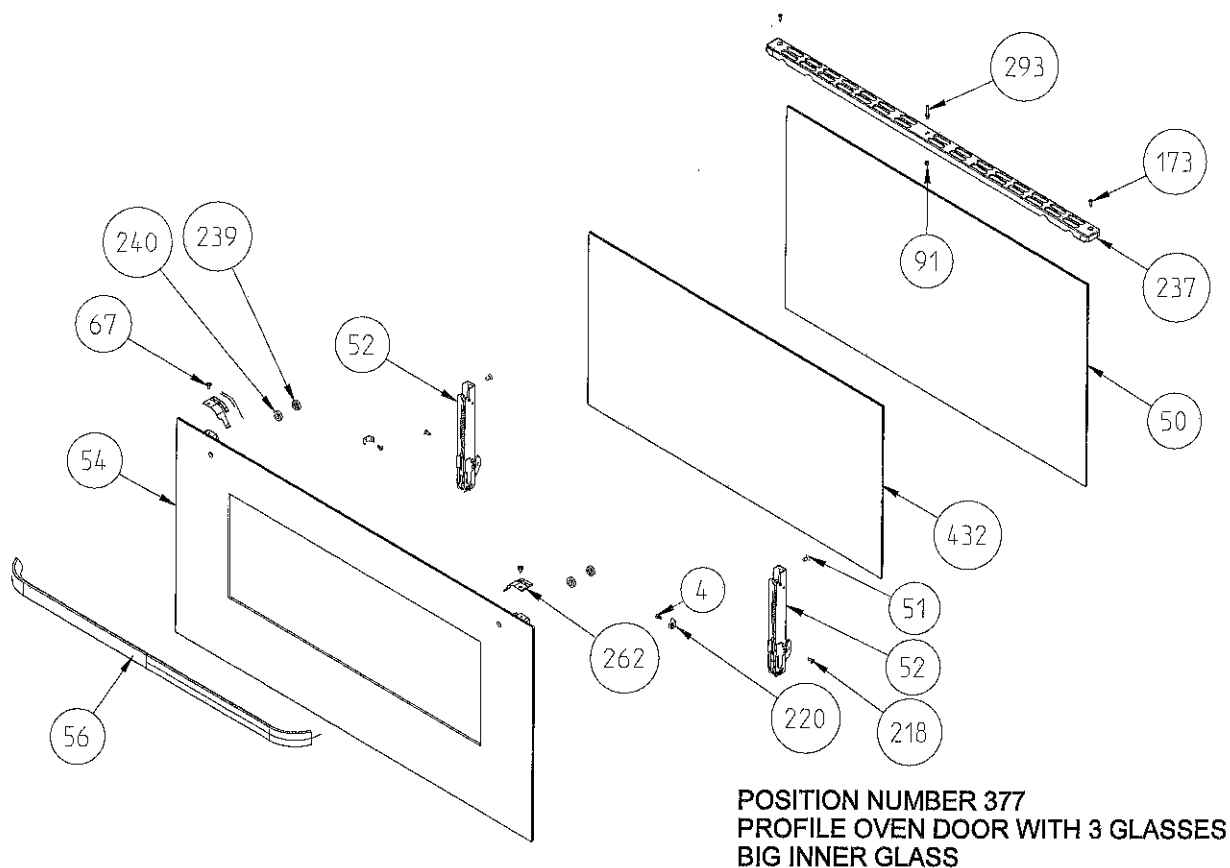
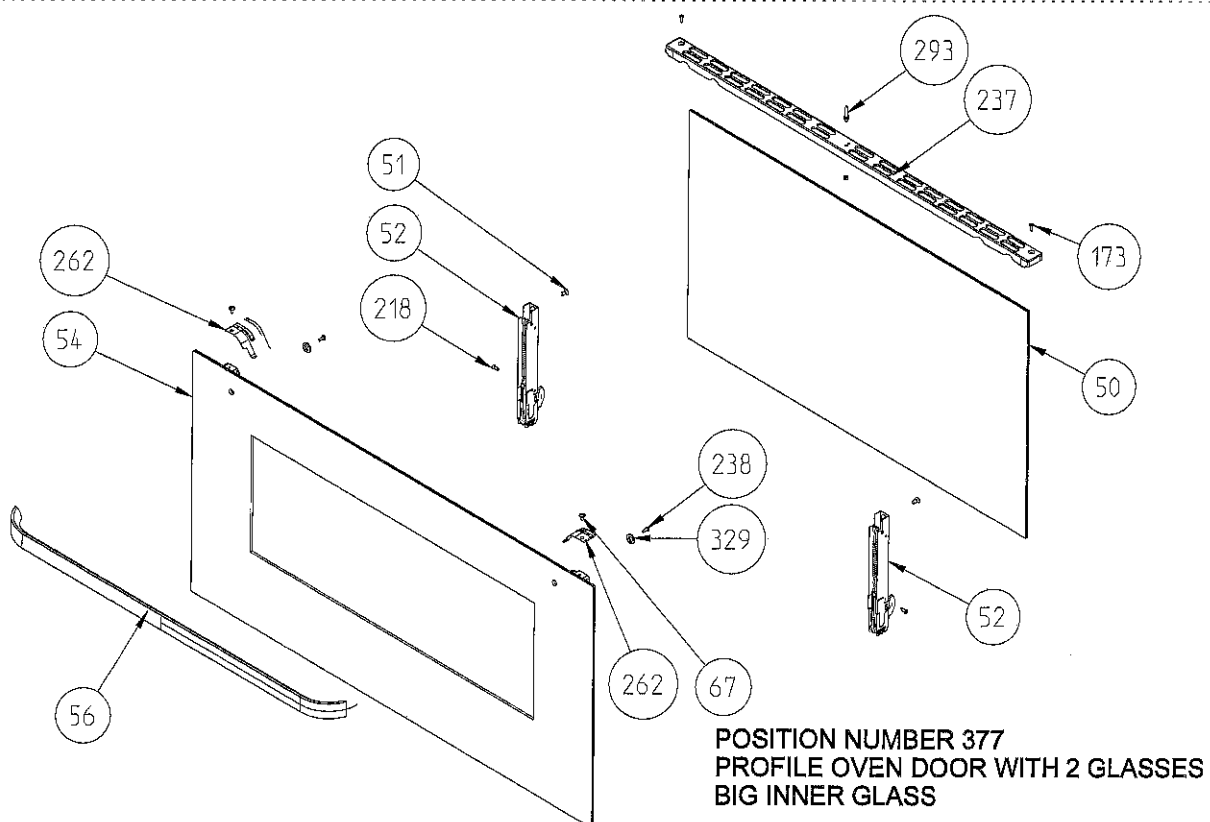

"The exploded views given in this document are generic. They include all possible versions of the product. For specific part codes, please refer to the bom list of regarding model."

90 CM FREE STANDING COOKER OVEN DOOR ASSEMBLY

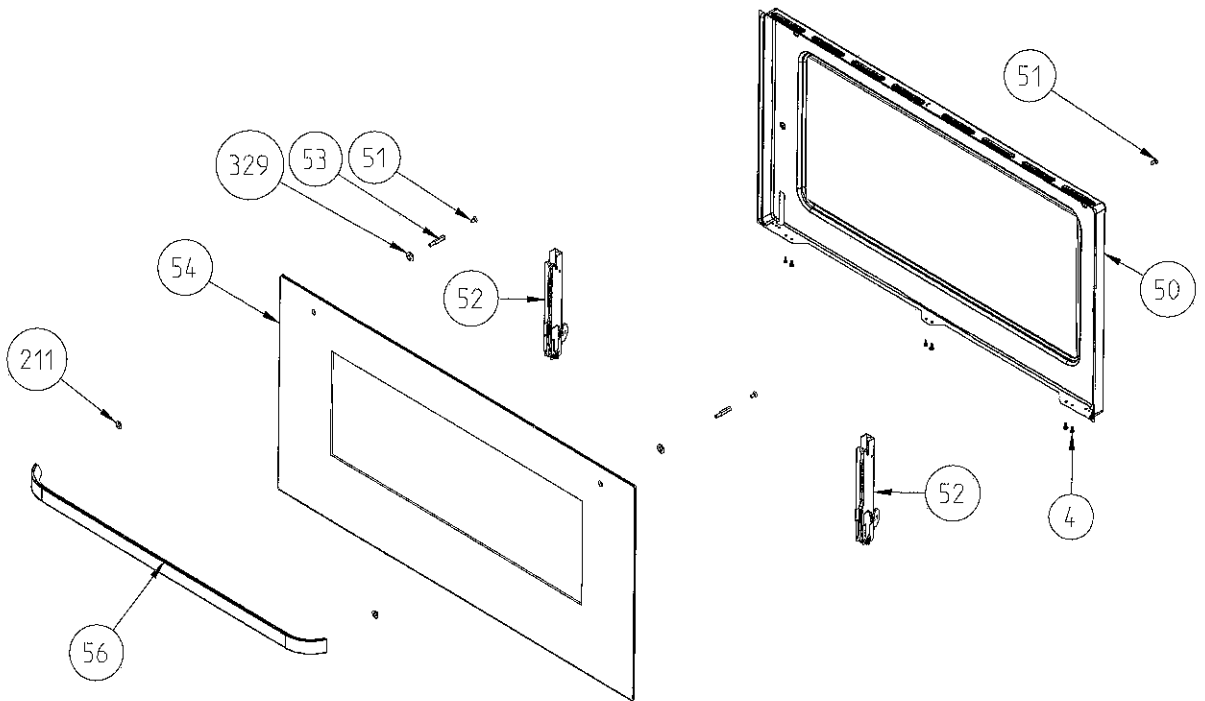

**POSITION NUMBER 378
FLAT TYPE OVEN DOOR WITH 2 GLASSES
(SMALL INNER GLASS)**

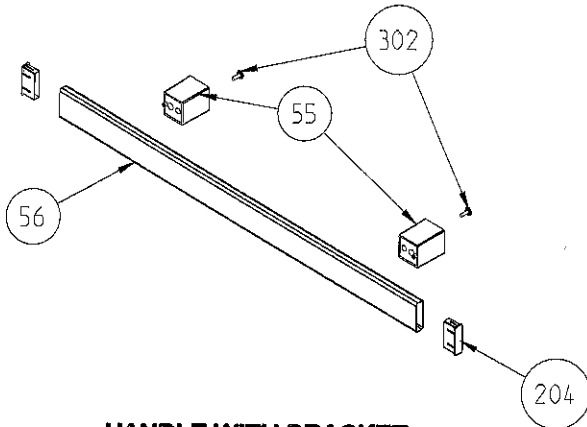

HANDLE WITH BRACKET

"The exploded views given in this document are generic. They include all possible versions of the product. For specific part codes, please refer to the born list of regarding model."

90 CM FREE STANDING COOKER DRAWER ASSEMBLY

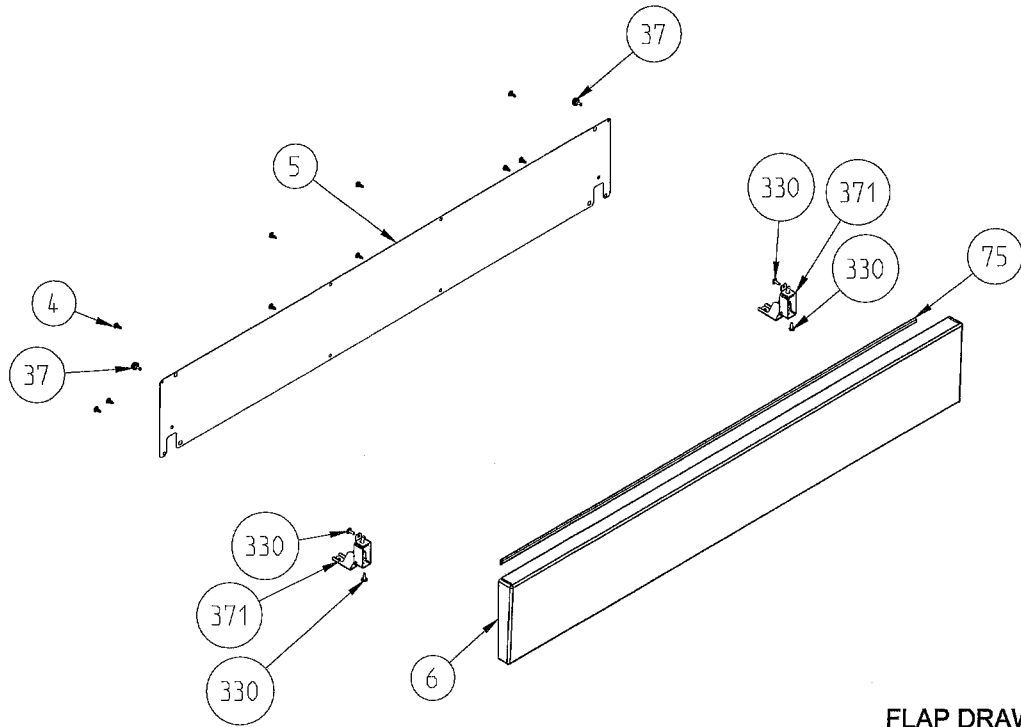

FLAP DRAWER ASSEMBLY

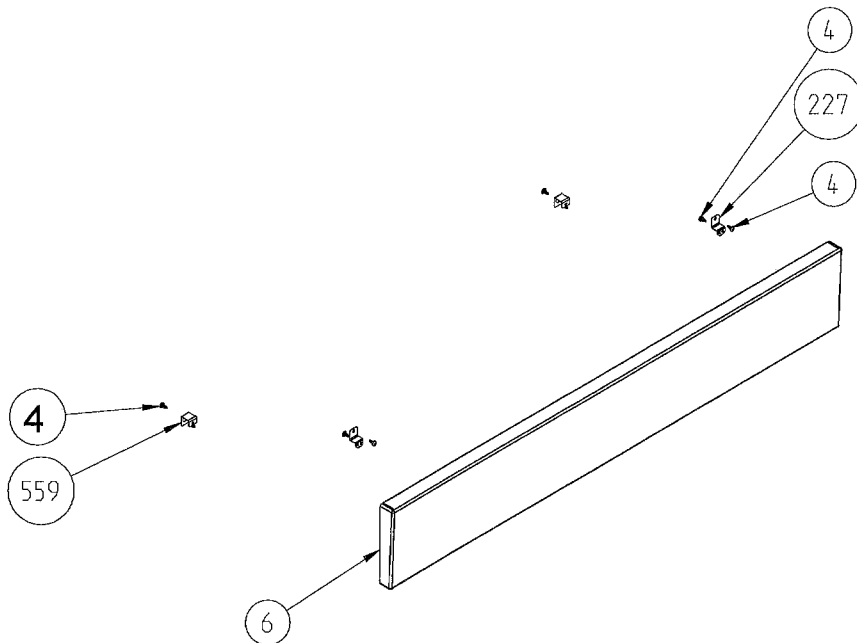

FIXED DRAWER ASSEMBLY

"The exploded views given in this document are generic.They include all possible versions of the product.
For specific part codes,please refer to the bom list of regarding model."

90 CM FREE STANDING COOKER SIDE PANEL ASSEMBLY

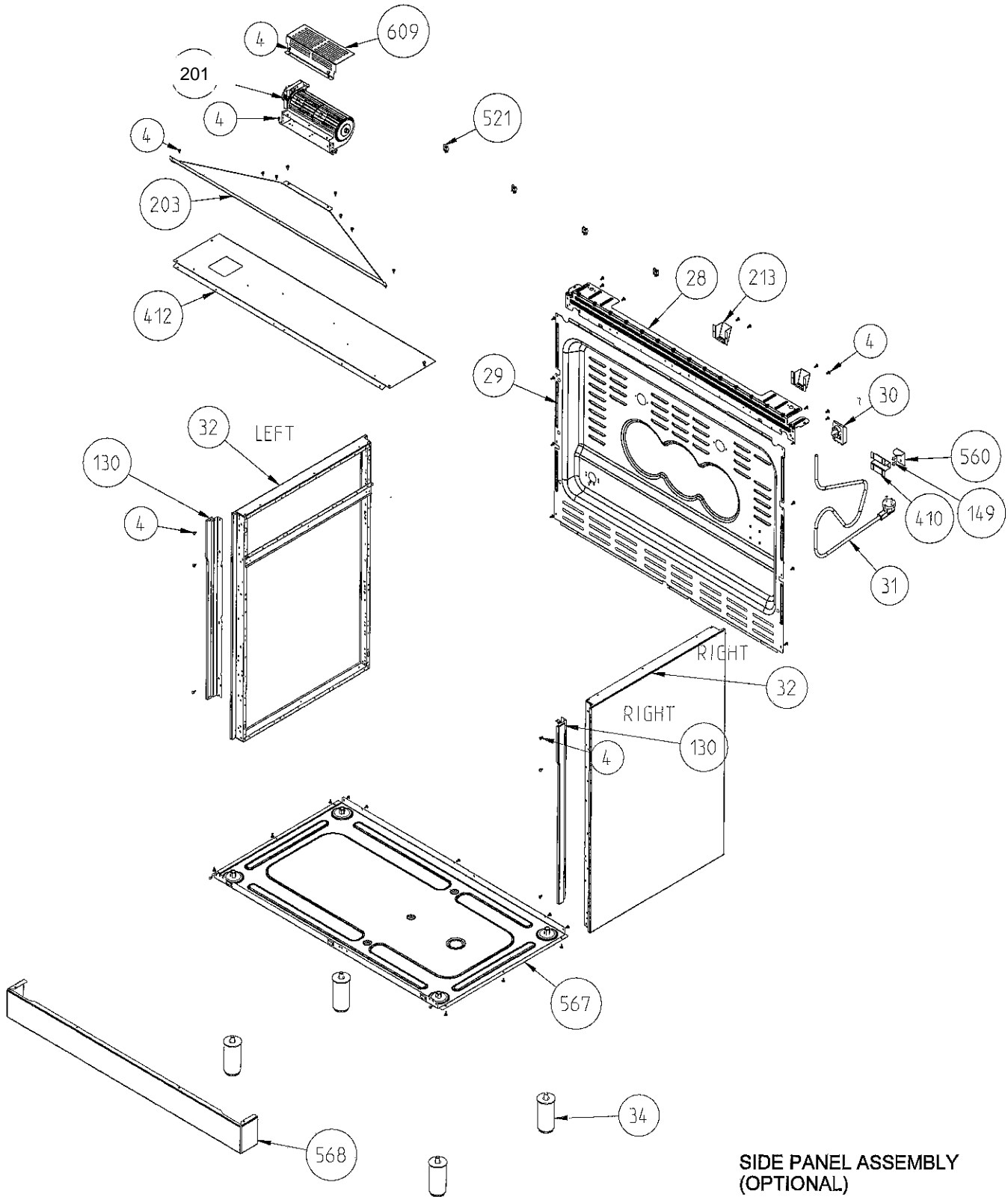

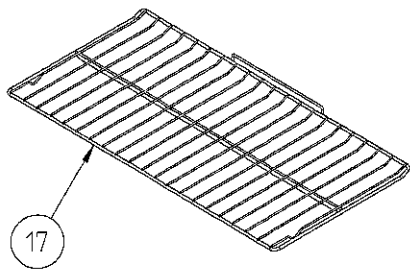

GRID

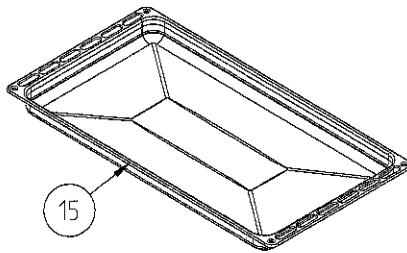

TRAY (DEEP)

Use Only for
bottle
compartment
product

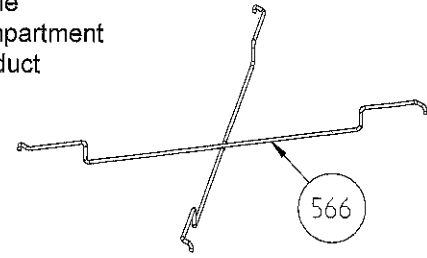

TUBE HOLDER WIRE

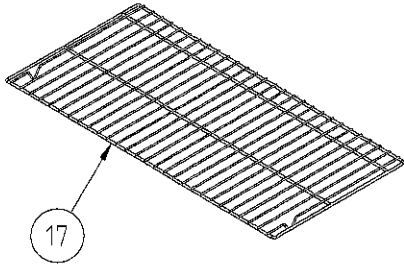

GRID (96,W.TELESCOPIC RAIL)

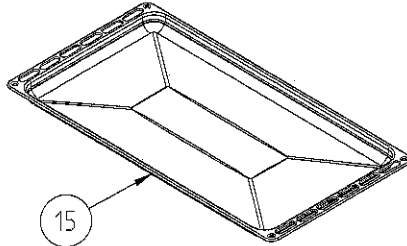

TRAY(SHALLOW)

Use Only for
bottle
compartment
product

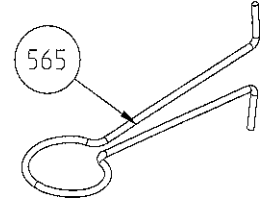

HOSE HOLDER WIRE

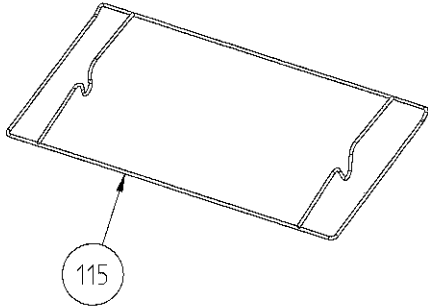

TURNSPIT GRID (MOULDED)

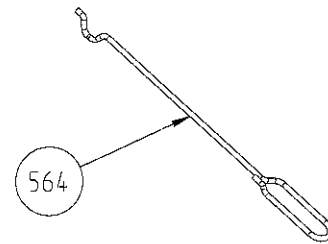

TURNSPIT HOLDER WIRE

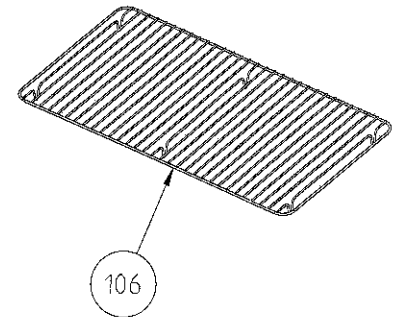

DEEP TRAY GRID

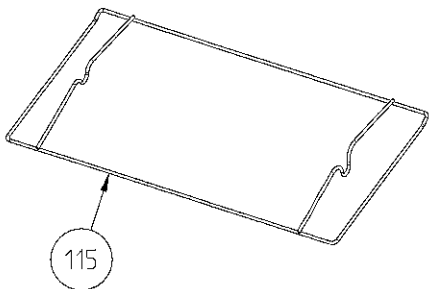

TURNSPIT GRID (TELESCOPIC RAIL)

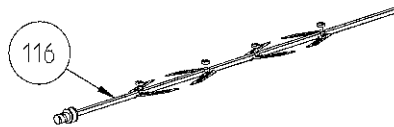

TURNSPIT SKEWER

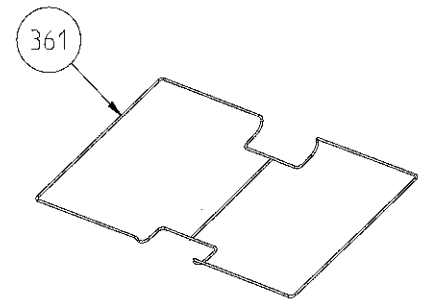

TELESCOPIC RAIL WIRE