

Reversing the door

Hold the top hinge cover and remove it toward that direction

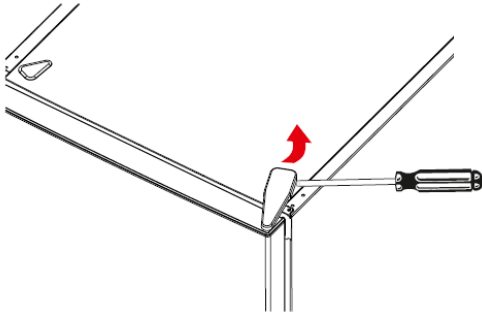

Unscrew the screws fixing the top hinge and remove it.

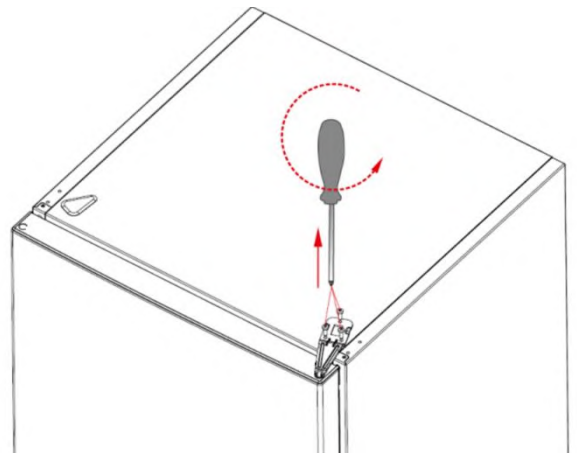

Displace the door

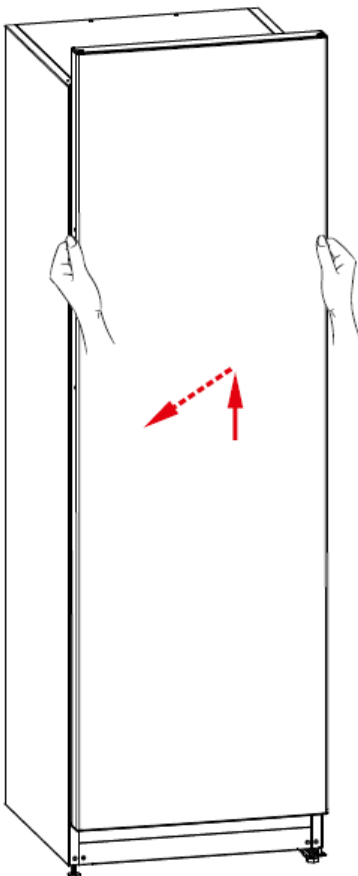

Unscrew the bottom hinge pin and screw it to other hole.

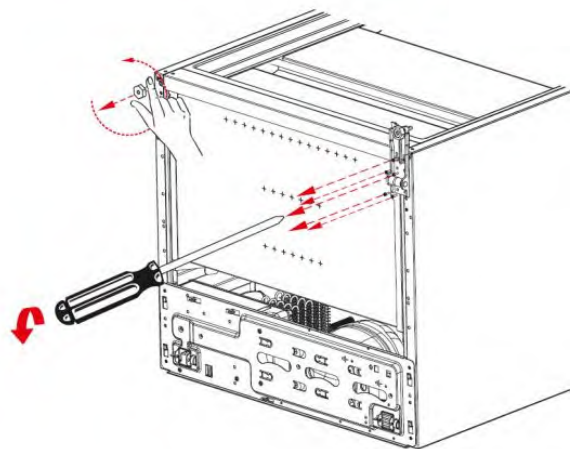

Thermostat Setting



Thermostat Control

Cooling compartment thermostat control

It ensures that the temperature settings in the cooling and freezing compartments of your frid freezer can be performed automatically. It may be set to any value ranging from the values 1 to 5. As you turn the thermostat setting knob from 1 to 5, you increase the cooling effect. To save energy in winter months, you may operate your refrigerator at a lower position.

Important note: Do not try to rotate knob beyond position 1 as it will stop your appliance.

Thermostat knob;

5 : For further cooling.

3 - 4 : For normal usage.

1 - 2 : For less cooling.

Replacing the light bulb

To replace the bulb in the fridge compartments;

- 1- Unplug your fridge freezer.
- 2- Using a screwdriver, carefully remove the light cover from the top panel. (a)
- 3- Replace with a 15 watt bulb. (b)
- 4- Reinstall the light cover. (c)
- 5- Wait for 5 minutes before re-plugging the fridge in and restore the thermostat to its original position.

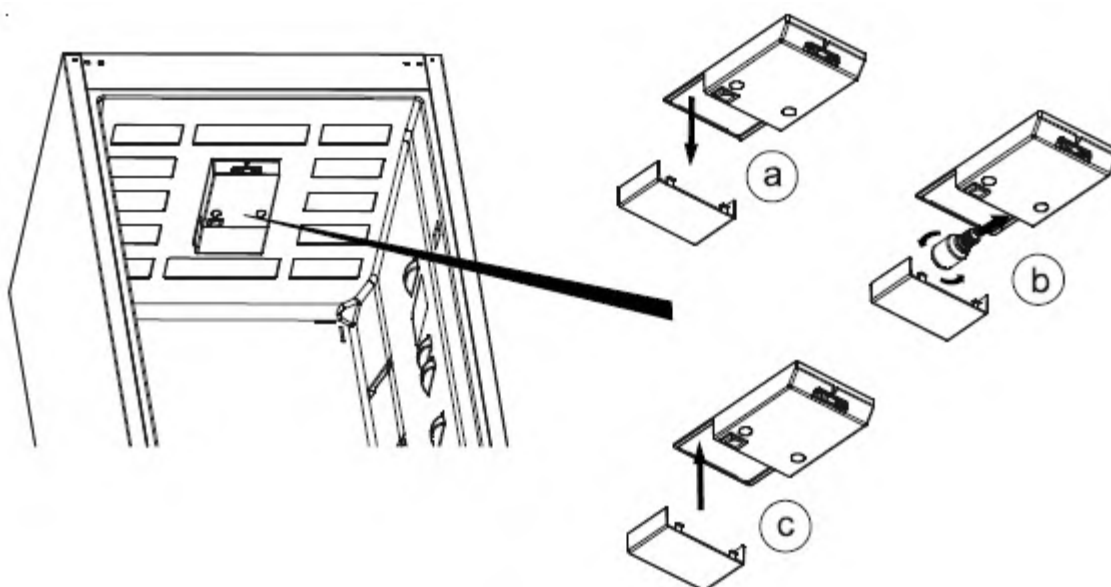

Replacing LED Lighting

If your fridge freezer has LED lighting contact the help desk as this should be changed by authorized personnel only.

Reversing the door

Unscrew the adjustable foot and unscrew the bottom hinge screws.

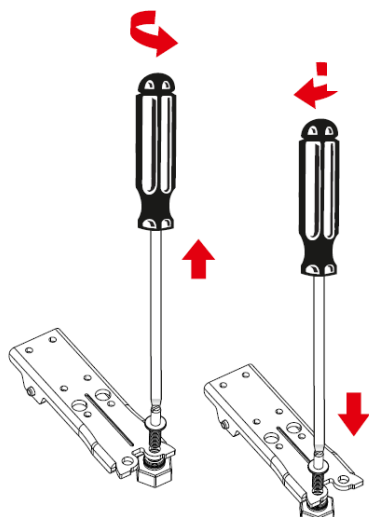

Screw the bottom hinge to the left bottom side of refrigerator.
Screw the adjustable foot there.

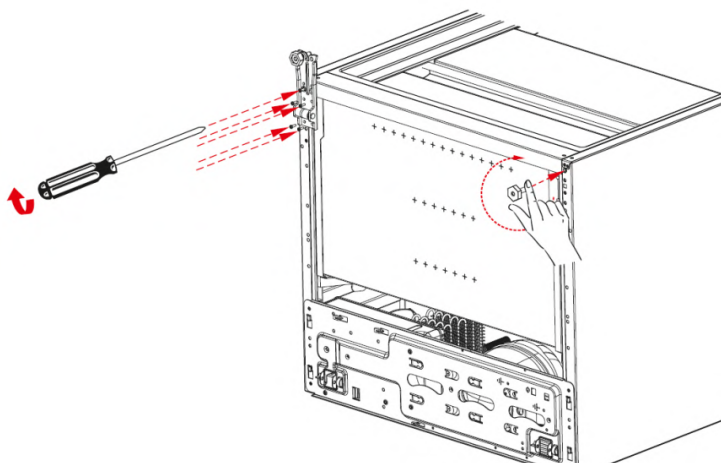

Unscrew the two screws fixing stopper and stopper support plate under the bottom door. After that screw the other side.

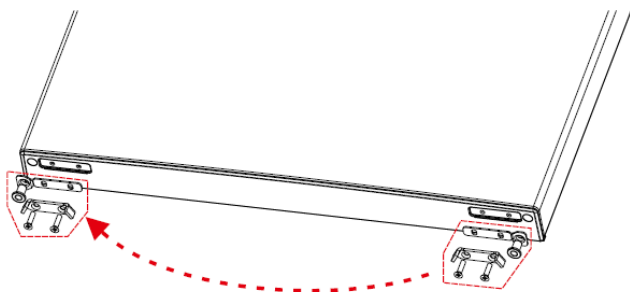

Reversing the door

Place the door to the bottom hinge and then connect the display connector and screw the top hinge to the top panel. Place the top hinge cover.

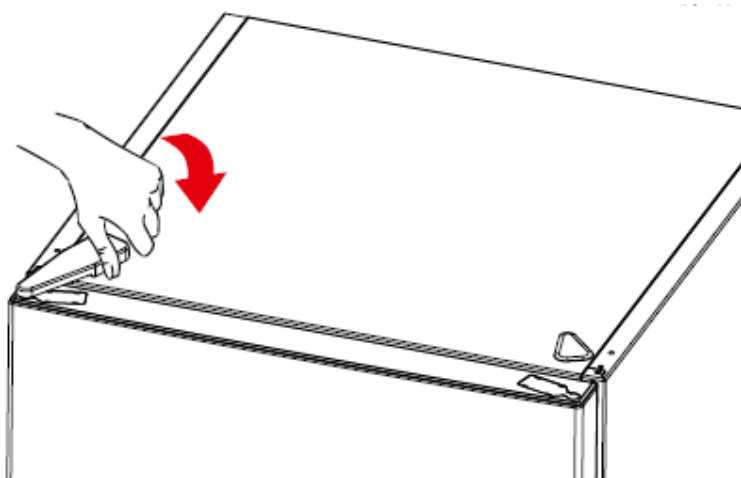
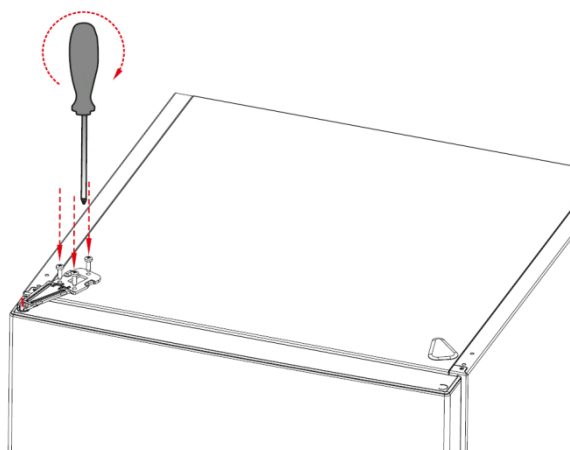
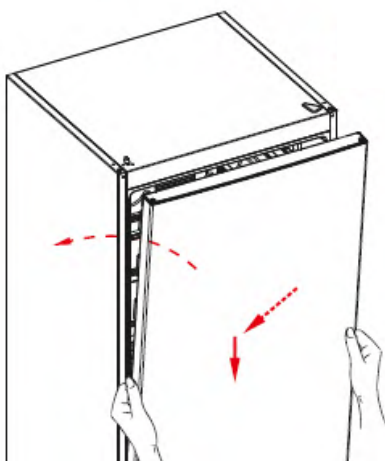



Remove the fan motor cover.

Unscrew the two screws and remove the fan motor body.

Take out the sockets and replace the fan motor.



Fan is supported
on rubber !



- 1 Fan red (+12 VDC)
- 2 Fan black (0 VDC)



Voltage: 12V DC

Power : 0,09A

Ohm meter → COM → Fan black → Resistor: 179 Ohm
OHM → Fan red



The plug must be pulled out before condanser is removed.

Dissassemble the back condanser by using the screwdriver to remove 4 screws.

Separate the compressor by using the plier to cut the welding connector.

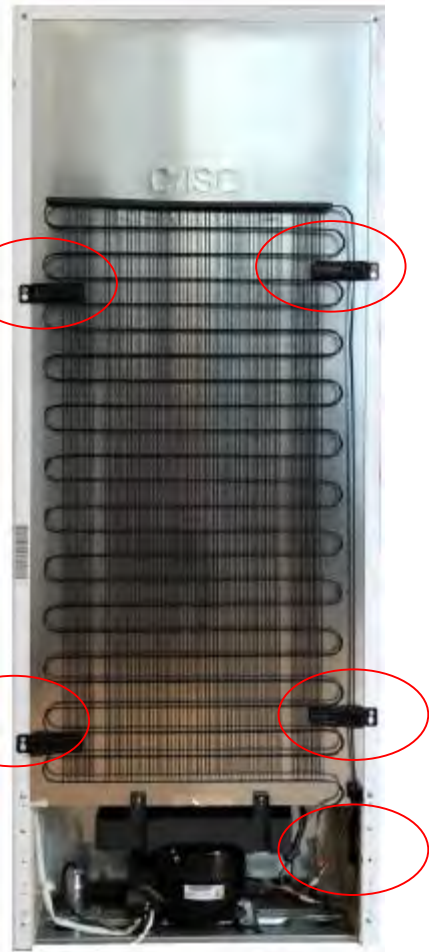

Condensation water tray

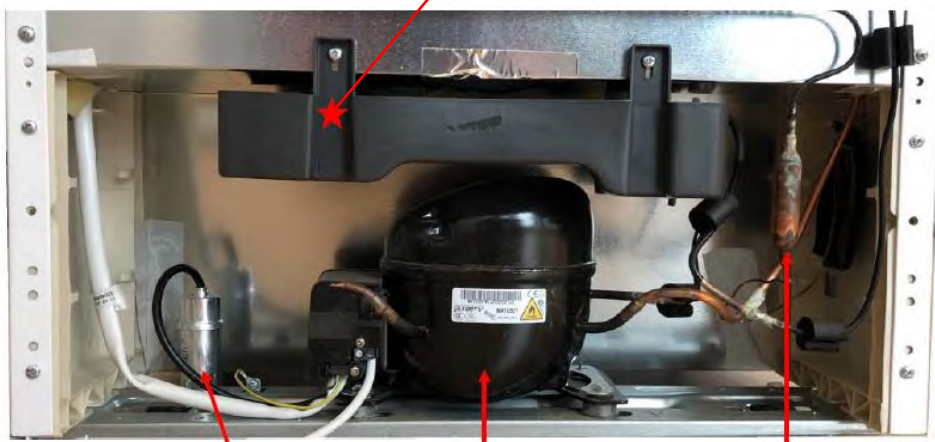

Capacitor
(Optional)

Compressor

Dryer

Pull the gasket towards starting from top right corner. Slowly pull the rest of the gasket. Completely remove the gasket from door.

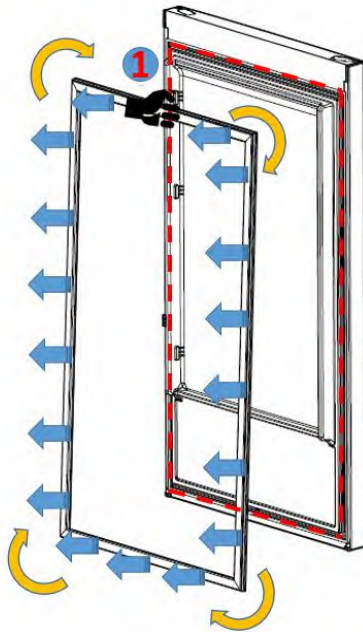

Check the replacement gasket form Starting with upper right corner, press on the gasket until it fits to its place.. Place the other sides of the gasket with the help of your thumb

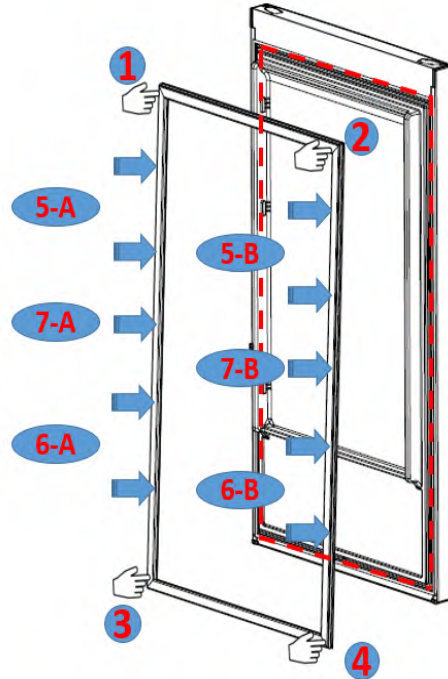

After the replacement check if there any non-fitting point on the gasket. Also check if there any opening at the gasket while the door is closed. If so that might cause condensation/icing or insufficient cooling/freezing. To prevent this soften the form of the gasket with the help of a hair dryer or hot water and make sure that all points are closing perfectly.



Vestel refrigerator serial numbers are consist of 22 digits.

