

TAVOLA B600 - 1.13



TAVOLA B600 - 2.28



734

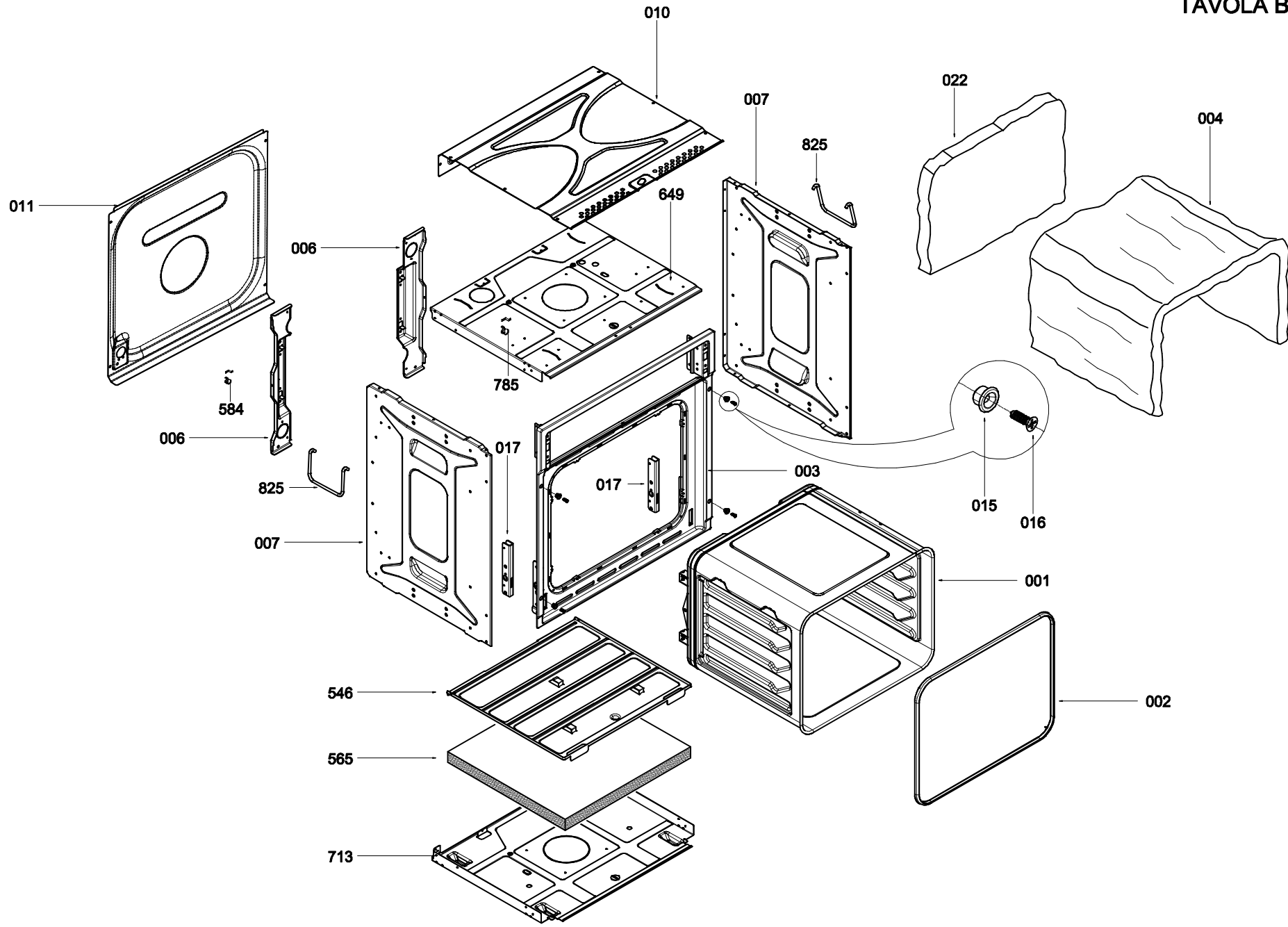
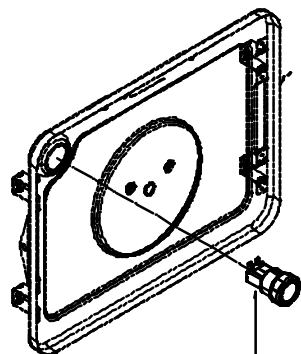

557

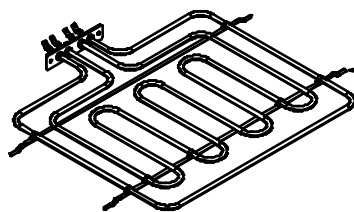

100

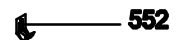

552

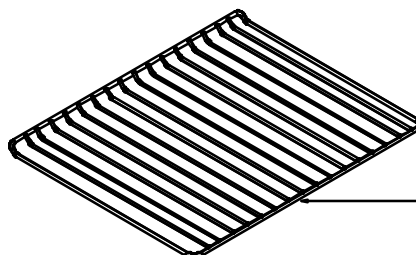

107

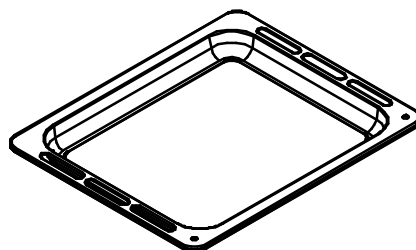

110

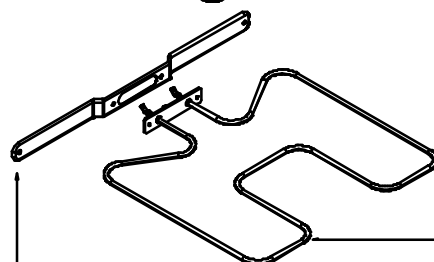

112

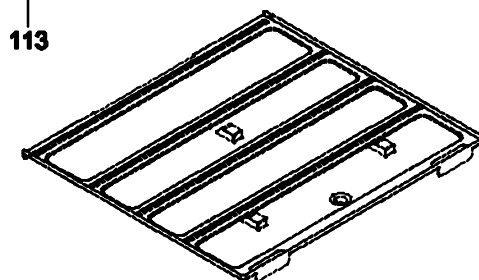

113

TAVOLA B600 - 3.58



TAVOLA B600 - 4.78



CODICE

000000752-0

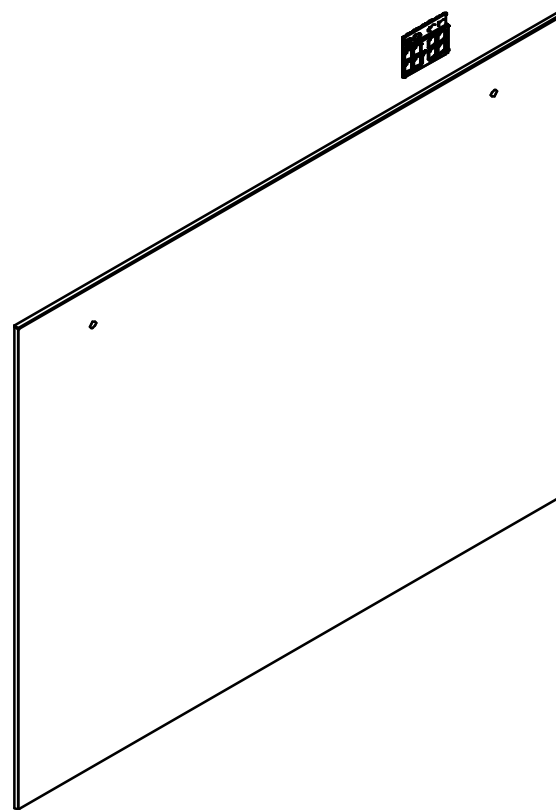
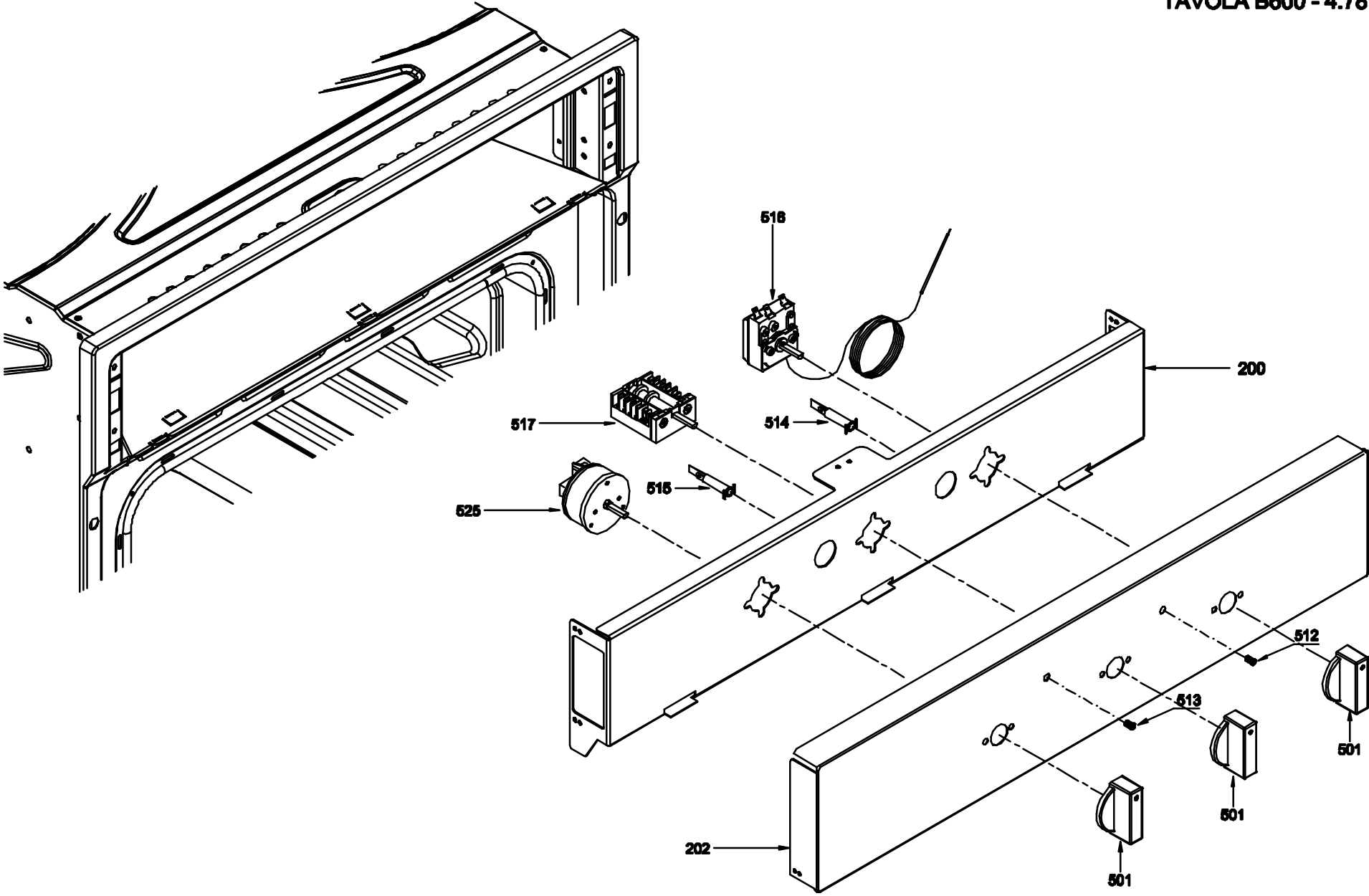
DESCRIZIONE

240000752 GRUPPO EL. B500E 4+0 RCIE+RGRI+2S S/TT
1110000752 CABLAGGIO B500EC 4+0 C/GRILL S/G.S/TT
1110000002 COMM. 4+0 46.25886.580
1110000431 FASCETTA SERRACAVO BIANCA
1110000458 LUCE SPIA GIALLA C/RES. ANTIL.TFL656PZT
1110000459 LUCE SPIA VERDE C/RES. ANTIL.TFL656PZ2

| | | |
|------------------|-----------------|----------------|
| DATA | 02/12/02 | DIS. DB |
| MODIFICHE | | DIS. |
| VISTO | U.T. | C.Q. |

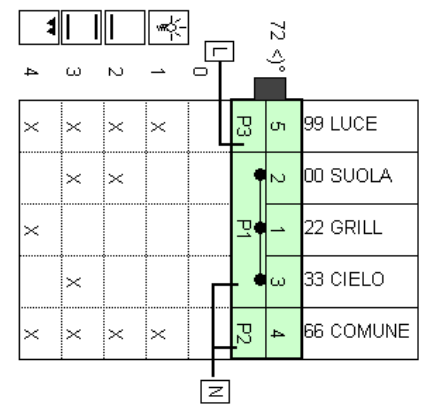
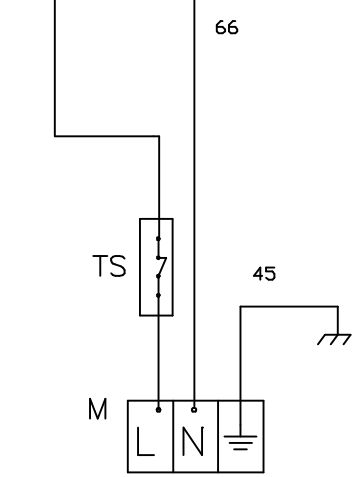
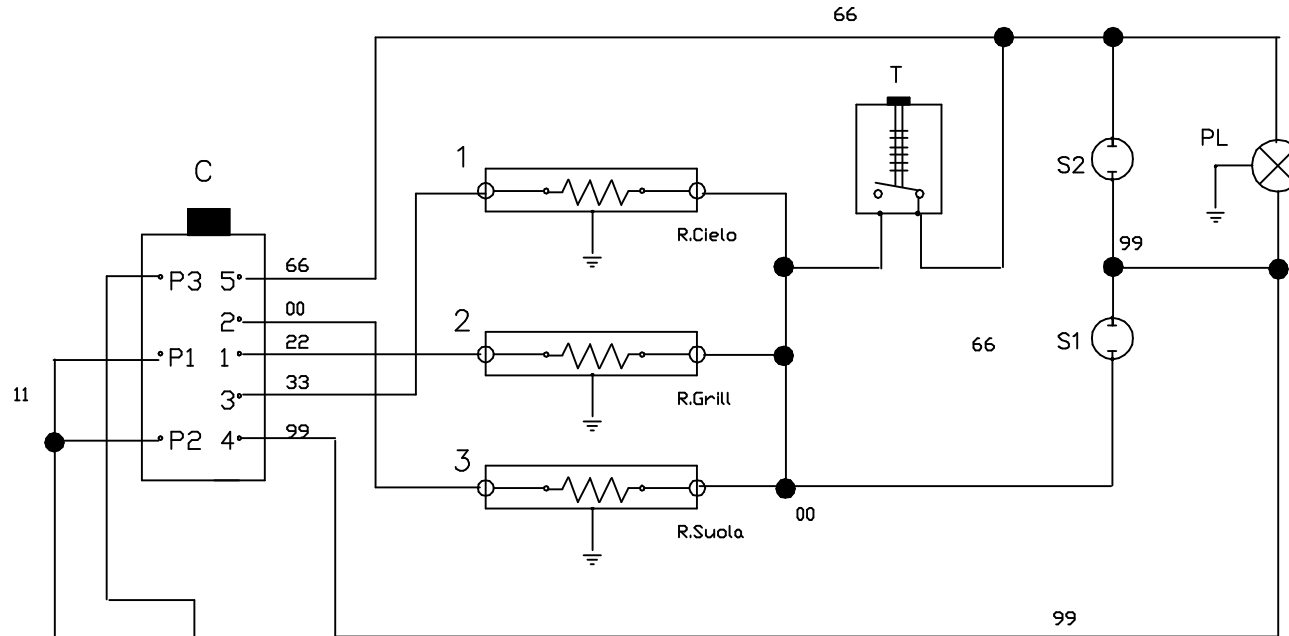

LuceFC=LUCE FINE COTTURA/END COOKING LIGHT

- A = ACCENSIONE/IGNITION
- BP=BLOCCO PORTA/DOOR LOCKING SYSTEM
- C = COMMUTATORE/SELECTOR
- C1 = COMMUT./SELECT.
- CA = CATALIZZATORE/CATALYST SYSTEM
- CM = COMMUT.PIASTRA/PLATE SELECT.
- D = DECODER TERMOSTATO/THERMOSTAT DEC.
- D1 = DECODER COMMUTATORE/SELECTOR DEC.
- FC = FINE COTTURA/END COOKING (120 min.)
- G = GIRAROSTO/TURNSPIT
- H = FILTRO ANTIDISTURBO/RADIO INTERFERENCE
- IA = MICRO ACCENSIONE/IGNITION SWITCH
- IG = MICRO GRILL/GRILL SWITCH
- IP = MICRO PORTA/DOOR SWITCH
- L = FASE/LIVE
- M = MORSETTIERA/TERMINAL BLOK
- M1 = MORSETTO LUCE PIANO/TERMINAL BLOK HOB SIGNAL LAMP
- MP = MANOPOLA TERM./KNOB THERM.
- MP1 = MANOPOLA COMMUTATORE/SELECTOR KNOB
- N = NEUTRO/NIUTER
- OA= OROLOGIO ANALOGICO/ANALOGUE CLOCK
- PA = PROG.ANALOGICO/ANALOGUE TIMER
- PE = PROG.ELETTRONICO/ELECTRONIC TIMER
- PL = LUCE FORNO/OVEN LIGHT
- PM = PROG.MECCANICO/MECHANICAL TIMER
- RE = REG.DI ENERGIA/ENERGY REG.
- SC = SCHEDA LED ICONE CIRCOLARI/LED WITH CIRCULAR ICONS
- SL = SCHEDA LED LINEARE CON DISPLAY/LINEAR LED WITH DISPLAY
- S1 = SPIA TERMOSTATO/THERM. SIGNAL LAMP (GIALLA/YELLOW)
- S2 = SPIA/SIGNAL LAMP (VERDE/GREEN)
- S3 = SPIA BL.PORTA/LOCKING DOOR S.LAMP
- S4 = SPIA PIROLISI/PYROLITIC S.LAMP
- SR = SPIA REG.DI ENERGIA/ENERGY REG.
- ST = SPIA VENTILATORE/COOLING FAN S.LAMP
- T = TERMOSTATO/THERMOSTAT
- TL = BAR-GRAPH TERMOSTATO/THERMOSTAT B.-G.
- TL1 = BAR/GRAPH COMMUTATORE/SELECTOR B.-G.
- TP = TERMOSTATO PIROLITICO/THERMOSTAT PYROLITIC
- TS = TERM.DI SICUREZZA/THERMAL CUT-OUT
- TT = TERM.VENTILATORE/COOLING FAN THERM.
- VR = VENTILATORE RADIALE/FAN MOTOR
- VT = VENTILATORE RAFFR./COOLING FAN
- KG = MESSA A TERRA GIRAROSTO/EARTING TERMINAL TURNSPIT
- KPL = M.T. PORTALAMPADA/H.T. LAMP HOLDER
- KRSUP = M.T. RESIST.SUPERIORE/H.T. TOP ELEM.
- KRINF = M.T. RESIST.INFERIORE/H.T. BOTTOM ELEM.
- KVR = M.T. MOT.RADIALE/H.T. FAN MOTOR
- KRCIR = M.T. RESIST.CIRCOLARE/H.T. CIRCULAR ELEM.
- KT = M.T. TERMOST. A GAS/H.T. GAS THERMOST.
- KPE = M.T. PROG./H.T. TIMER
- KVT = M.T. VENTILATORE/H.T. COOLING FAN
- KP = M.T. PIANO/H.T. HOB
- Ktel = M.T. TELAIO/H.T. OUTER FRAME
- 1 = RESISTENZA CIELO/TOP HEATING ELEM.
- 2 = RESISTENZA GRILL/GRILL HEATING ELEMENT
- 3 = RESISTENZA SUOLA/BOTTOM HEATING ELEMENT
- 4 = RESISTENZA CIRCOLARE/CIRCULAR HEATING ELEM.

- IT/CB
- 00 = NERO/BLACK
- 11 = MARRONE/BROWN
- 22 = ROSSO/RED
- 33 = ARANCIONE/ORANGE
- 44 = GIALLO/YELLOW
- 45 = GIALLO-VERDE/YELLOW-GREEN
- 66 = BLU/BLUE
- 77 = VOLA/VIOLET
- 88 = GRIGIO/GREY
- 99 = *BIANCO/WITHE (*B-W)
- 90 = *B-NERO/W-BLACK
- 91 = *B-MARRONE/W-BROWN
- 92 = *B-ROSSO/W-RED
- 93 = *B-ARANCIONE/W-ORANGE
- 94 = *B-GIALLO/W-YELLOW
- 95 = *B-VERDE/W-GREEN
- 96 = *B-BLU/W-BLUE
- 97 = *B-VOLA/W-VIOLET
- 98 = *B-GRIGIO/W-GREY